

USB Reflective Optoelectronic Switch (IRSW21A)

1、 Product image



2、 Product Description

The USB Reflective Optoelectronic Switch (IRSW21A) is a customizable USB switch. It is equivalent to a standard USB keyboard and mouse with a single button, and the button functions can be set through accompanying software. After the function settings are completed, there is no need for software cooperation during use, and it can be used normally with a different computer. This product is widely used in printer automatic printing, mobile monitoring, proximity monitoring, and other occasions. The functional description is as follows:

1.Keyboard function: It can be set to any key value or combination of keys (including F13 to F24, etc.), for example, it can set to key value A or CTRL+A function.

2.Mouse function: It can be set as the left, center, right, forward, and backward key functions of the mouse, as well as the movement of the X and Y axes and the up and down scrolling function of the scroll wheel.

3.String printing function: Up to 38 characters can be set for printing, For example, setting www.pcsensor.com.

4.Multimedia function: Supports multimedia functions such as previous, next, volume up, volume down, etc.

5.Macro definition function: It is possible to set a series of keyboard and mouse actions, such as setting Ctrl+P to delay for 100ms and then press enter to achieve automatic printing function.

3、 Product parameters

1. Product Name: USB Reflective Optoelectronic Switch
2. Product model: IRSW21A
3. Interface type: USB interface
4. Working current: 5V@20mA
5. Trigger distance: 15-80cm
6. Inductive probe size: ϕ 18 * 50mm
7. Cable length: 2 meters
8. Product weight: approximately 85 grams

4、Instructions for use

The device is connected to a computer through a USB interface, which is equivalent to a USB keyboard and mouse and can be set to any keyboard or mouse function. The switch adopts a reflective photoelectric triggering method. When an object approaches, infrared light will be reflected back to the panel through the object. The internal receiving tube will receive the reflected light signal and trigger it (equivalent to pressing a button). For example, if it is set to the left mouse button function, when an object approaches, it will trigger the left mouse button pressing function on the computer.

Trigger distance adjustment: There is a potentiometer at the head and tail of the sensor. Rotate clockwise to adjust the trigger distance, and rotate counterclockwise to adjust the distance to be closer.

Function settings:

Provide configuration software for Windows and MAC, software download address <http://software.pcsensor.com>. Download the latest version of ElfKey software and install it. Connect the product to the USB interface of the computer and run the ElfKey software, as shown in the following picture:

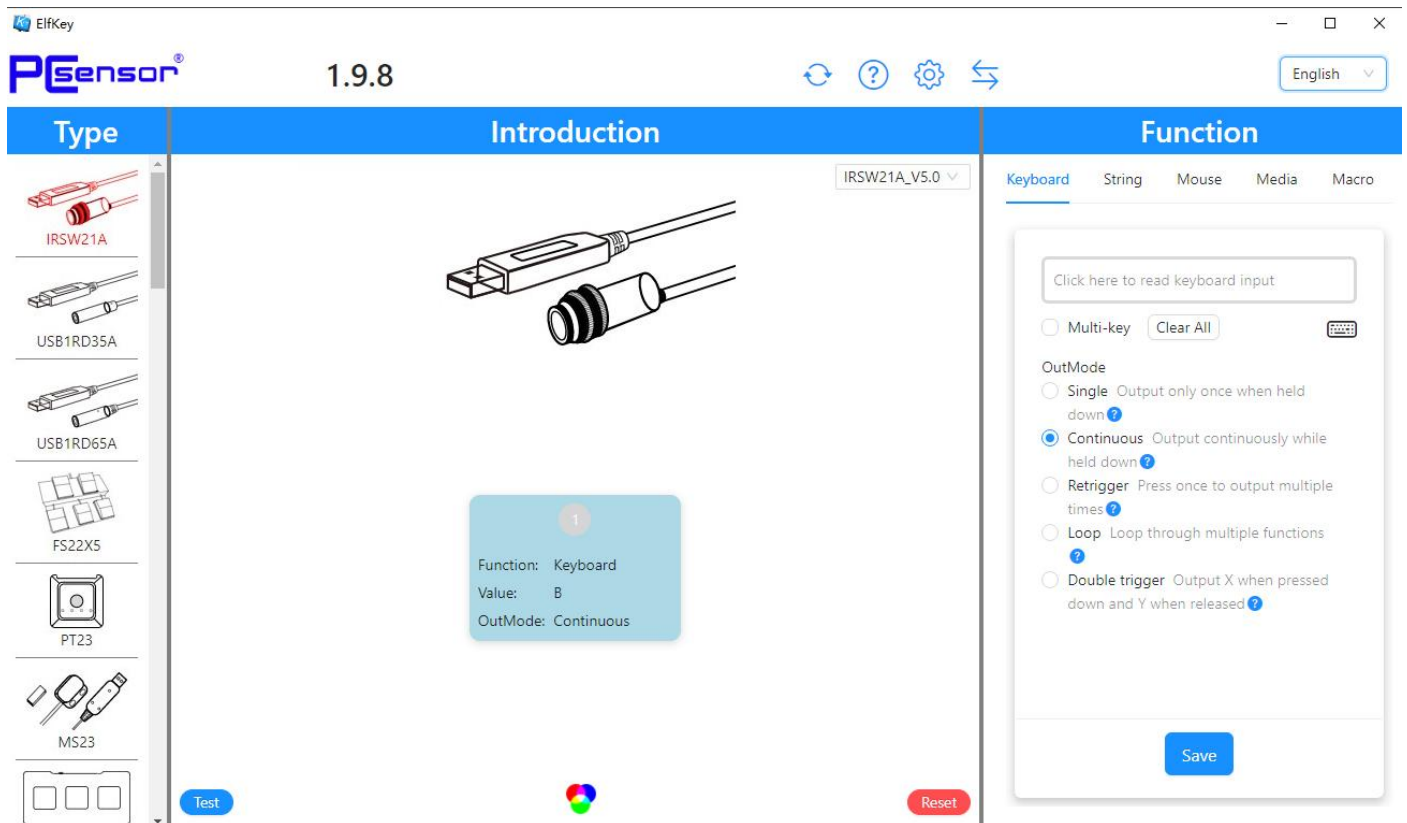

Select the function to be set in the function settings section, then click the "Save" button. Wait for a moment and it will prompt "Save successfully" to complete the button function setting.